

# LJP-( )-( )

## Conduit Mounted Underwater Junction Box

**Construction:** Cast bronze with stainless steel fasteners.

**Grounding:** Internal grounding lug for each fixture.

**Gasket:** Flat black neoprene rubber.

**Riser:** Supplied with single or double 3/4" red brass riser(s) with integral waterstop flange and grounding lug.

**Cord Seals:** Machined brass, compression type for 16-3 or 10-3 type STOW submersible cable, factory installed.

**Safety:** Underwriters Laboratories Listed for underwater and dry applications.

**Optional:** For junction box without conduit riser, add suffix **-L** to catalog number.



| Model Number | Power |      | Lighting |              |
|--------------|-------|------|----------|--------------|
|              | Qty   | Size | Qty      | Size         |
| LJP-1(*)     | 1     | 3/4" | 1 to 10  | 1/2" or 3/4" |
| LJP-2(*)     | 2     | 3/4" | 1 to 10  | 1/2" or 3/4" |

\* Specify required number of lighting connections. (A maximum of eight 3/4" connections for 10-3 cable may be made.)

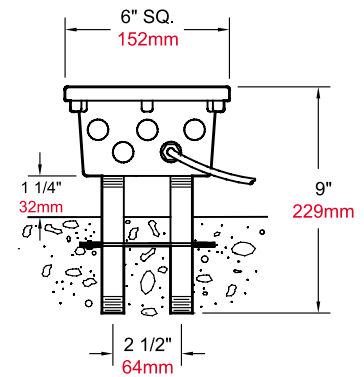
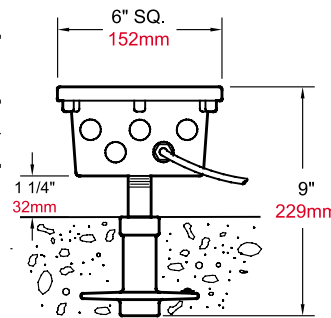

Speaking the language of water.™

