

FSD-()

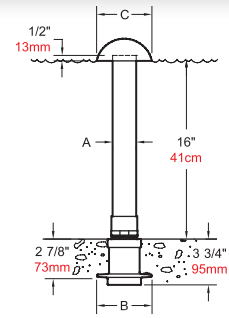

Overflow Standpipe Drain

- Cast bronze body with integral waterstop flange and ground screw.
- Cast bronze cap and copper standpipe in natural finish.
- Threaded connection.
- Available with British Standard Pipe Threads, add **-BSP** to catalog number.



Model Number	NPT	Dimensions					
		Inches			Millimeters		
		A	B	C	A	B	C
FSD-150	1 1/2"	1 5/8	5	2 3/4	41	127	70
FSD-200	2"	2 1/8	7	5	54	127	127
FSD-300	3"	3 1/8	7	5	79	178	127

R-()B



Overflow Standpipe Drain

- Cast bronze adjustable drain hub with removable copper standpipe and cast bronze top cap.
- Cast iron hub with membrane clamping ring.
- Single locking screw for easy removal.
- Threaded connection.

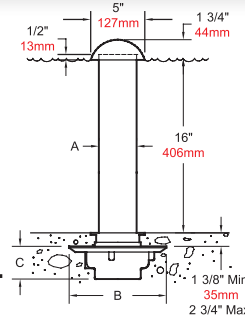

Model Number	NPT	Dimensions					
		Inches			Millimeters		
		A	B	C	A	B	C
R-15B	2"	2 1/8	9	3	54	229	76
R-16B	3"	3 1/8	9	3	79	229	76

FWD-300B



Wall Mounted Overflow Fitting

- All brass with natural finish.
- Large full-face removable strainer.
- Integral waterstop flange with ground screw.
- 3" FPT connection.

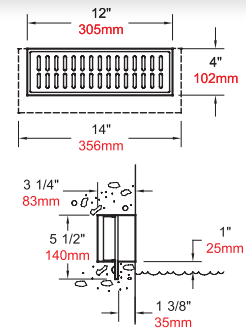

FWD-()B



Wall Mounted Overflow Fitting

- All brass with natural finish.
- Large full-face removable strainer.
- Integral waterstop flange with ground screw.
- 2" FPT connection.

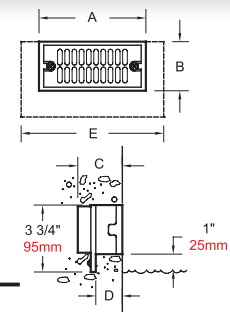

Model Number	Dimensions									
	Inches					Millimeters				
	A	B	C	D	E	A	B	C	D	E
FWD-200B	6	2 3/4	2 5/8	1 1/2	8	152	70	67	38	203
FWD-200SB	9 1/4	1 1/2	3 3/8	2	11 1/4	235	38	79	51	292